

STATE OF NORTH CAROLINA
DEPARTMENT OF TRANSPORTATION
HIGHWAY DIVISION 6

PLANS

Letting Date: October 1, 2025

CONTRACT ID: DF00532

TIP NO.: -----

FEDERAL AID NO.: STATE FUNDED

WBS ELEMENT NO.: 2026CPT.06.06.20781.1

ROUTE NO.: VARIOUS

LOCATION: VARIOUS

COUNTY: ROBESON

LENGTH OF PROJECT: 22.21 MILES

TYPE OF WORK: MILLING, RESURFACING & PAVEMENT MARKINGS

Robeson County Resurfacing, 2026

Contract: DF00532

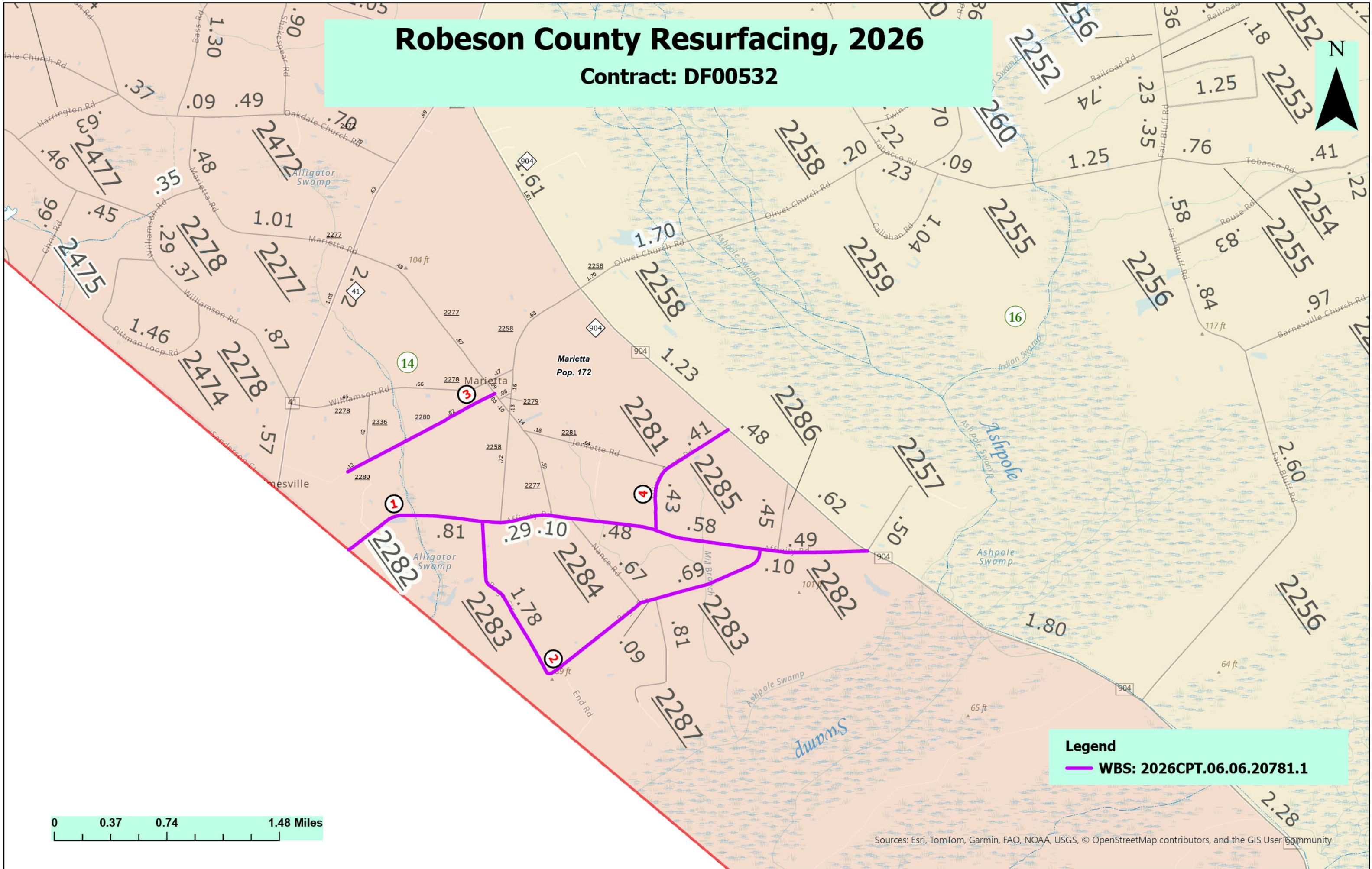

14

16

Marietta
Pop. 172

1

4

2

Legend
— WBS: 2026CPT.06.06.20781.1



Sources: Esri, TomTom, Garmin, FAO, NOAA, USGS, © OpenStreetMap contributors, and the GIS User Community

Robeson County Resurfacing, 2026

Contract: DF00532

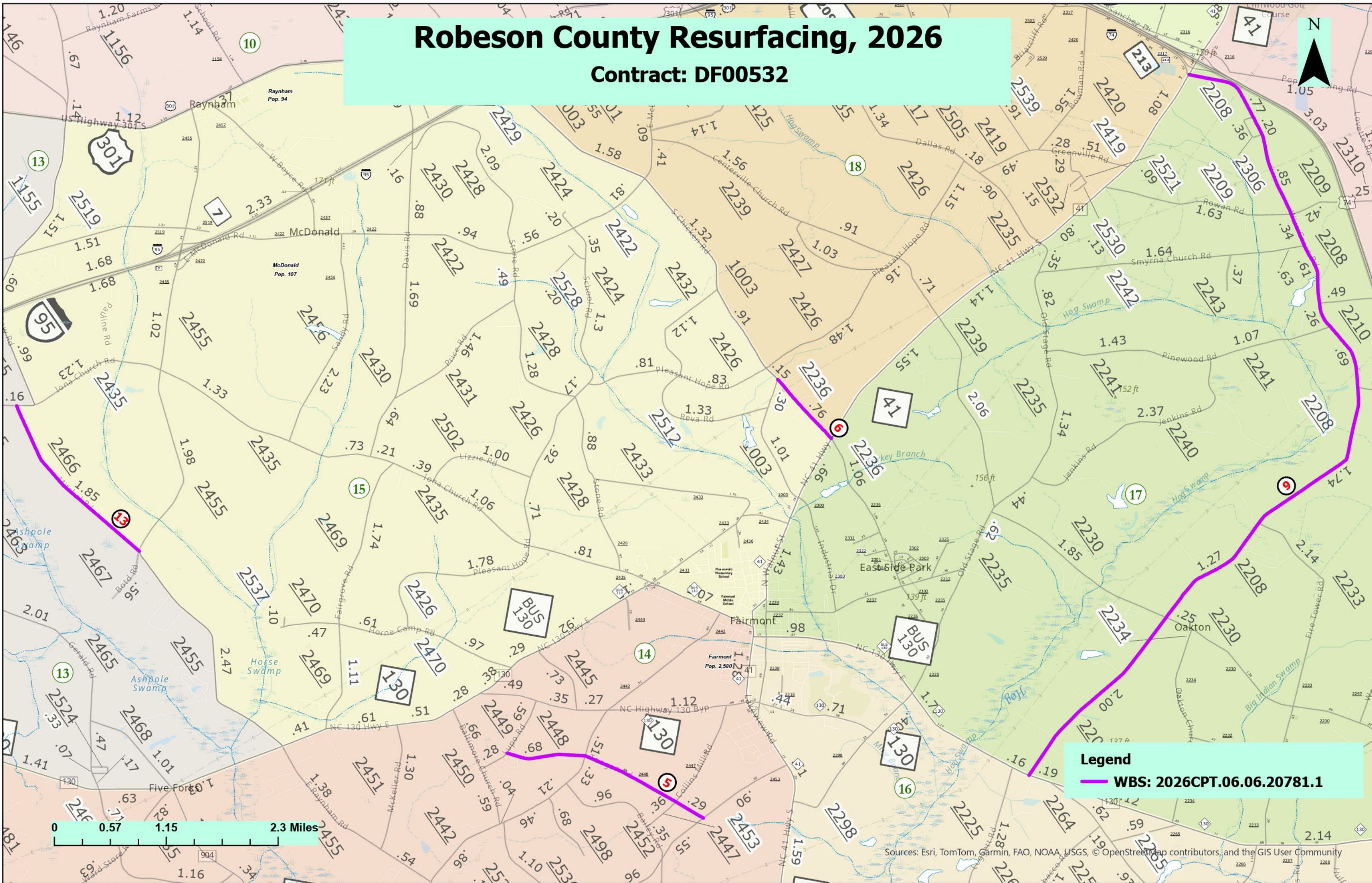

Legend
— WBS: 2026CPT.06.06.20781.1

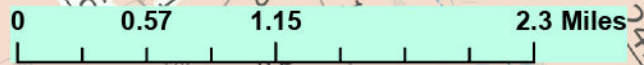

Sources: Esri, TomTom, Garmin, FAO, NOAA, USGS, © OpenStreetMap contributors, and the GIS User Community

Robeson County Resurfacing, 2026

Contract: DF00532



Legend
— WBS: 2026CPT.06.06.20781.1

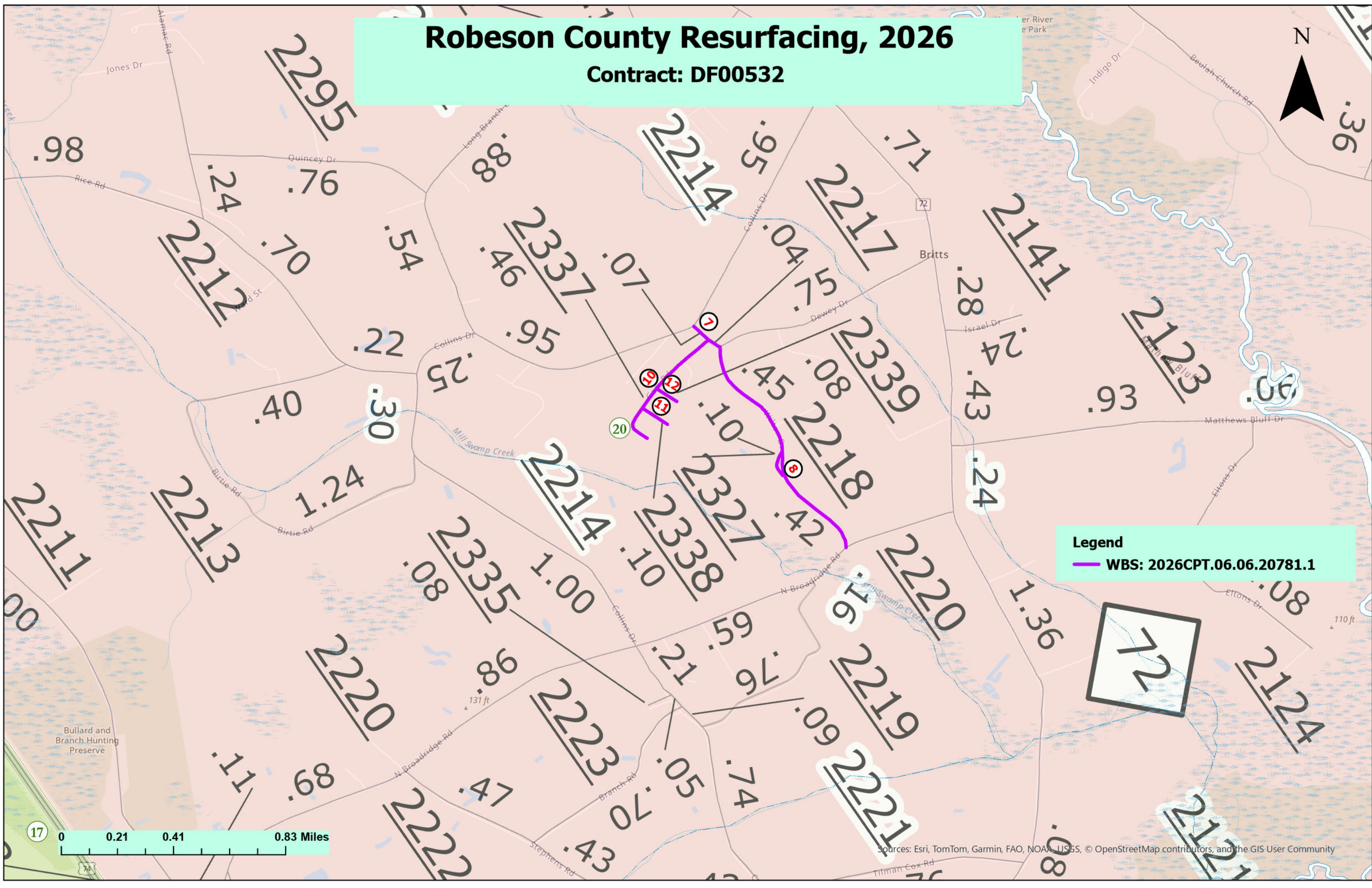

Sources: Esri, TomTom, Garmin, FAO, NOAA, USGS, © OpenStreetMap contributors, and the GIS User Community

PAVEMENT SCHEDULE

C1	1" ASPHALT CONCRETE SURFACE COURSE, TYPE S9.5B, AT AN AVERAGE RATE OF 110 LBS. PER SQ. YD.
C2	1½" ASPHALT CONCRETE SURFACE COURSE, TYPE S9.5B, AT AN AVERAGE RATE OF 165 LBS. PER SQ. YD.
E1	5" ASPHALT CONCRETE BASE COURSE, TYPE B25.0C, AT AN AVERAGE RATE OF 570 LBS. PER SQ. YD.
E2	5½" ASPHALT CONCRETE BASE COURSE, TYPE B25.0C, AT AN AVERAGE RATE OF 627 LBS. PER SQ. YD.
T1	SHOULDER RECONSTRUCTION WITH AGGREGATE SHOULDER BORROW
U	EXISTING PAVEMENT
V1	0" - 1½" MILLING (INCIDENTAL MILLING)
V2	1½" MILLING
V3	5" MILLING

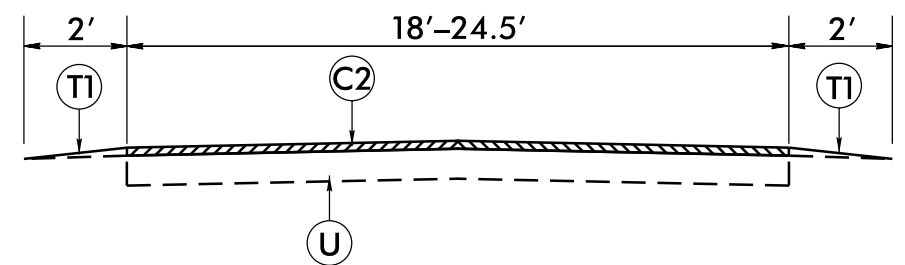

TYPICAL SECTION NO. 1

-PLUS 2' INSIDE CURVE WIDENING (SEE DETAIL)
 -MAP 4 - PLUS 5" MILL AND FILL 10' x 159' (SEE DETAIL 1)

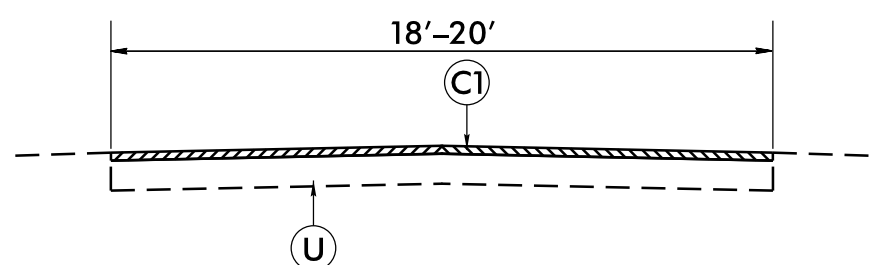

TYPICAL SECTION NO. 2

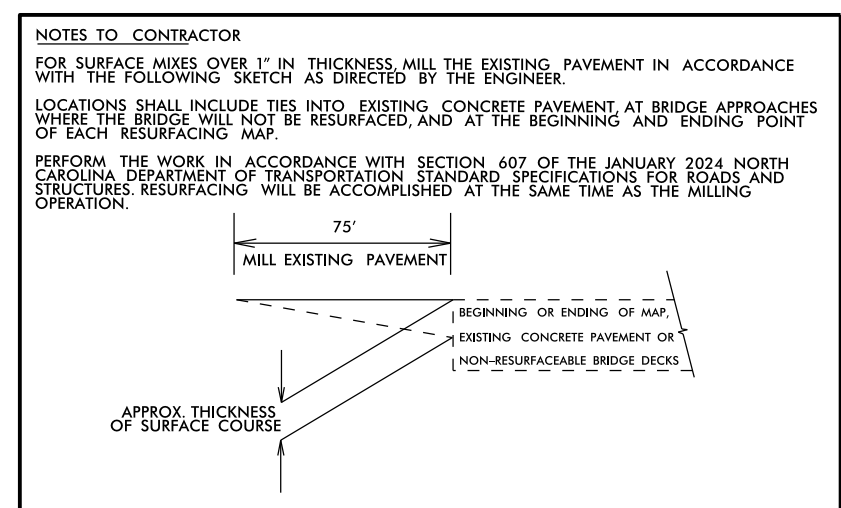
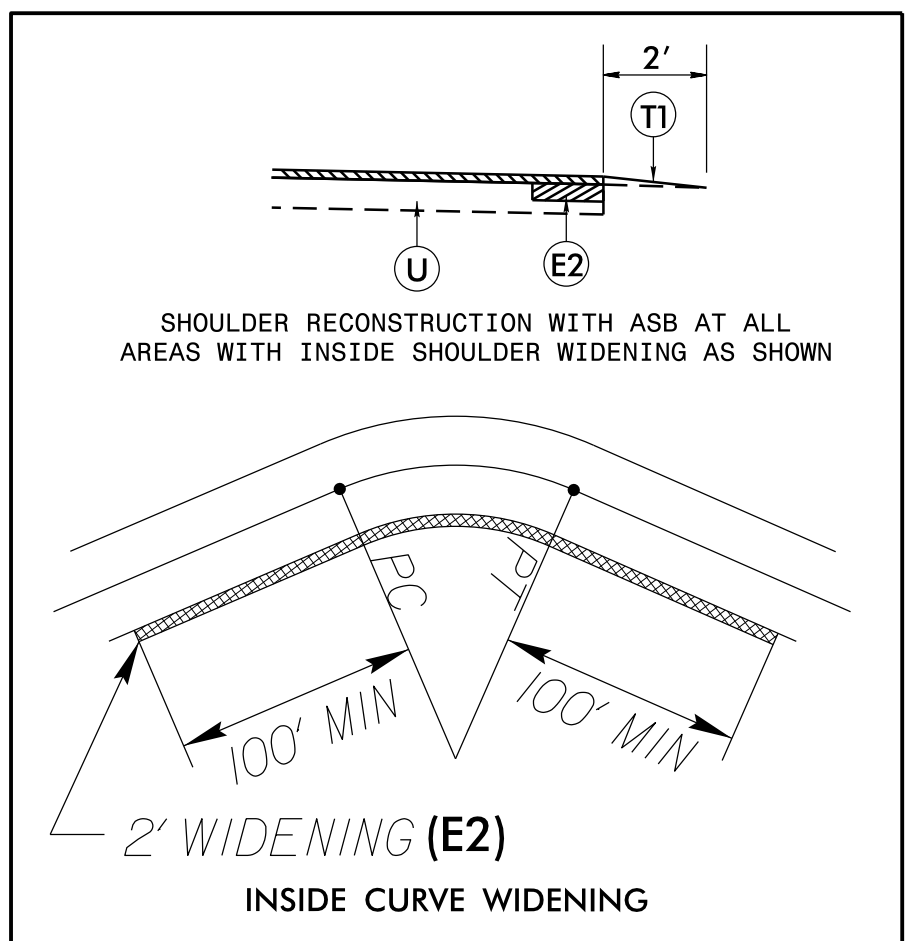
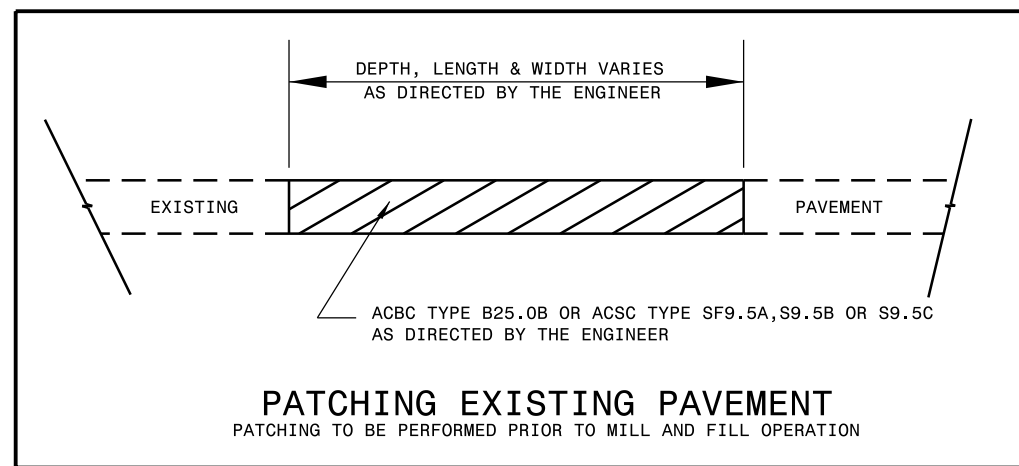
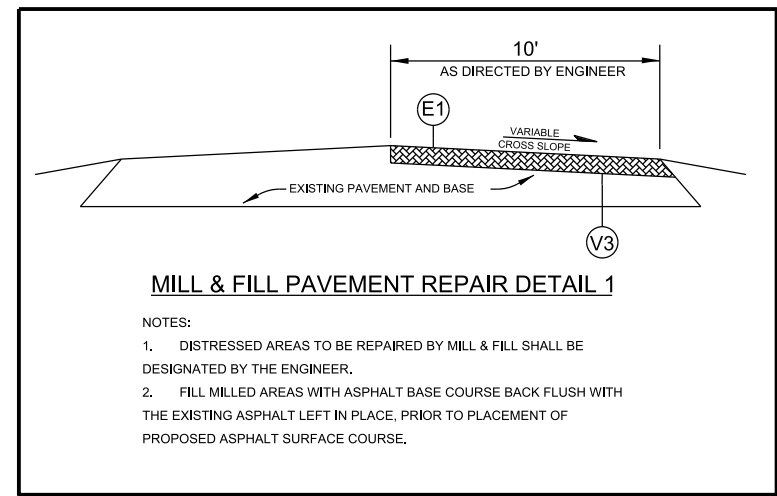
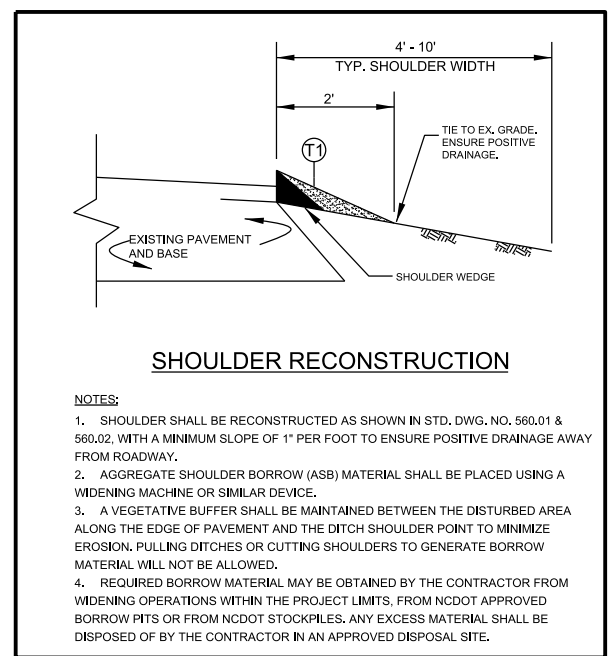
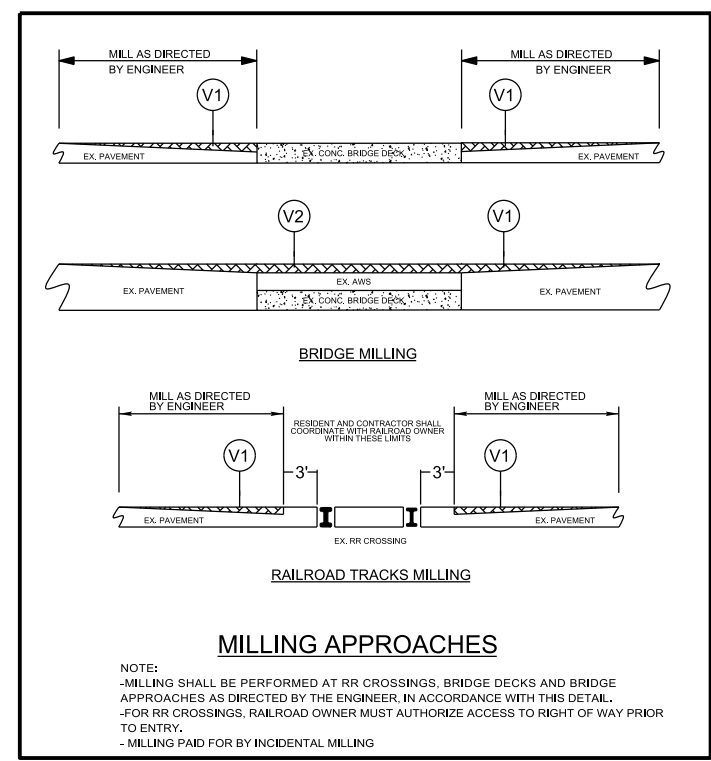

6/2/99
 Q:\SEP-2025\16-47\1\Engineer\District 1\2025\Resurfacing\DF00532-2025CPT\06.06.20781.1.Fall 2025\Plans\TYPICAL Scdg
 3/23/2025 10:58:59 AM

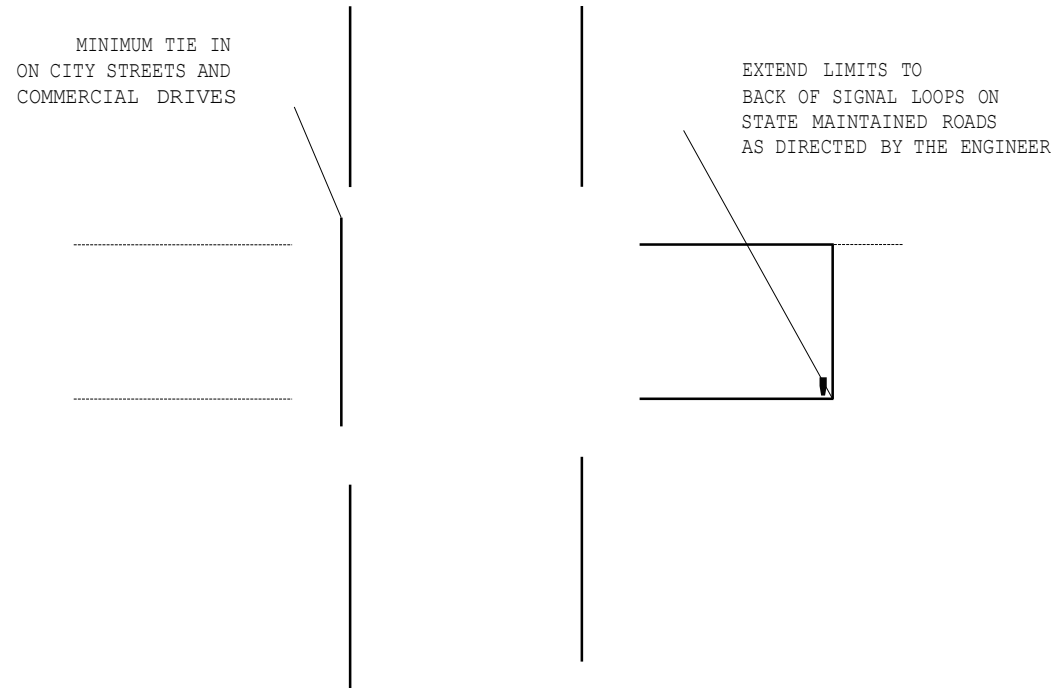

TYPICAL DETAIL OF PROJECT LIMITS AT SIGNALIZED Y LINES

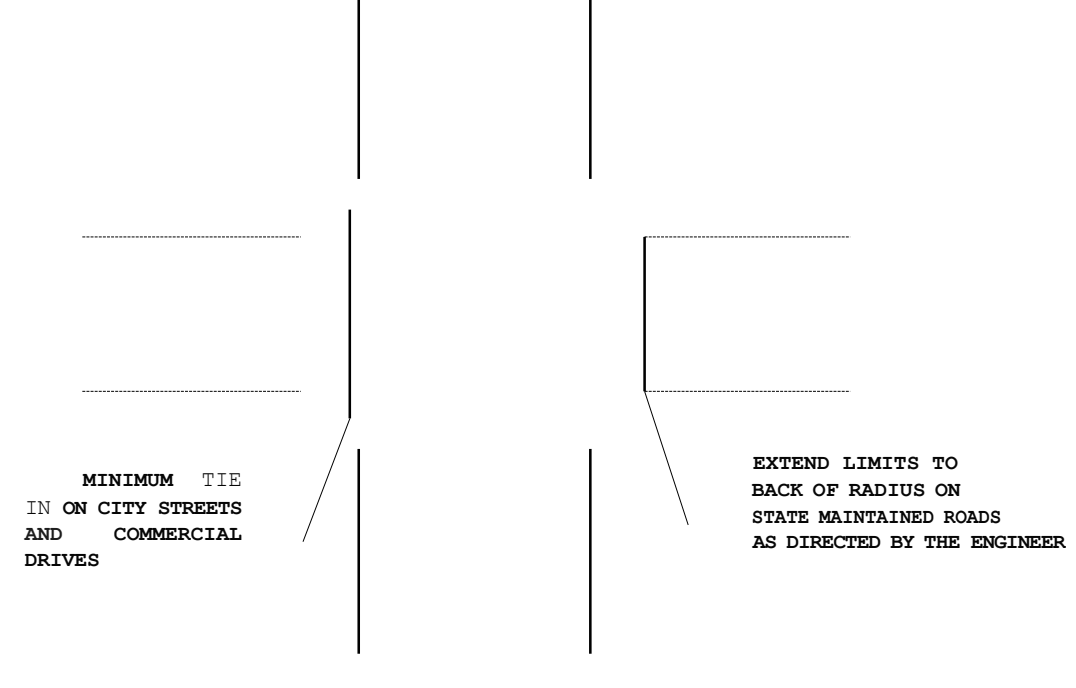

TYPICAL DETAIL OF PROJECT LIMITS AT UNSIGNALIZED Y LINES

ADDITIONAL INTERSECTIONS (NON-TYPICAL)

Extend paving limits to back of radius
or loop on the following intersections:

MAP#	STREET NAME	COMMENTS
1	SR 2286 (Homestead Road) RT	70 FT from EP of L-Line = 369 SY
1	SR 2284 (Nance Road) LT	65 FT from EP of L-Line = 376 SY
1	SR 2277 (Marietta Road) RT	62 FT from EP of L-Line = 424 SY
1	SR 2258 (Olivet Church Road) RT	62 FT from EP of L-Line = 346 SY
2	SR 2287 (Mill Run Road) LT	45 FT from EP of L-Line = 129 SY
2	SR 2284 (Nance Road) RT	60 FT from EP of L-Line = 327 SY
3	SR 2336 (Gilchrist Road) LT	105 FT from EP of L-Line = 528 SY
4	SR 2281 (Jenerettee Road) RT	74 FT from EP of L-Line = 489 SY
7	SR 2217 (Dewey Drive) LT	93 FT from EP of L-Line = 650 SY
9	SR 2306 (Little Rod Road) RT	35 FT from EP of L-Line = 128 SY
9	SR 2306 (Little Rod Road) RT	38 FT from EP of L-Line = 102 SY
9	SR 2209 (Rowan Road) RT	83 FT from EP of L-Line = 466 SY
9	SR 2209 Rowan Road) LT	70 FT from EP of L-Line = 368 SY
9	SR 2442 (Smyrna Church Road) RT	64 FT from EP of L-Line = 269 SY
9	SR 2210 (Old Kingsdale Road) LT	130 FT from EP of L-Line = 713 SY
9	SR 2241 (Pinewood Road) RT	55 FT from EP of L-Line = 243 SY
9	SR 2311 (Fred Road) LT	82 FT from EP of L-Line = 511 SY

- NOTES:
- 1) DETAIL DOES NOT APPLY TO OGAFB AND ULTRA-THIN BONDED WEARING COURSE.
 - 2) BACKFILL SHOULDER WITH APPROVED MATERIAL.
 - 3) THE SHOULDER WEDGE DEVICE MAY BE DISENGAGED AT PAVED DRIVEWAYS AND SIDE STREETS.

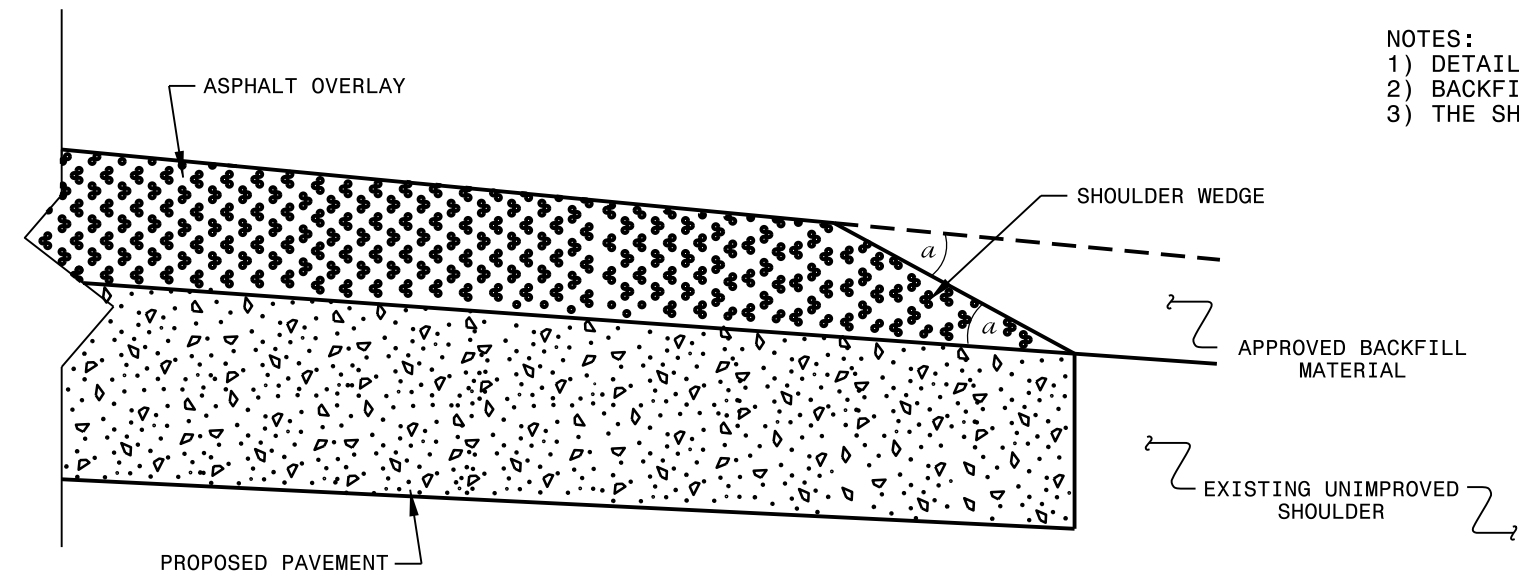

SHOULDER WEDGE DETAIL
 (Resurfacing Projects w/ Widening or
 with Existing Paved Shoulder having no dropoffs)

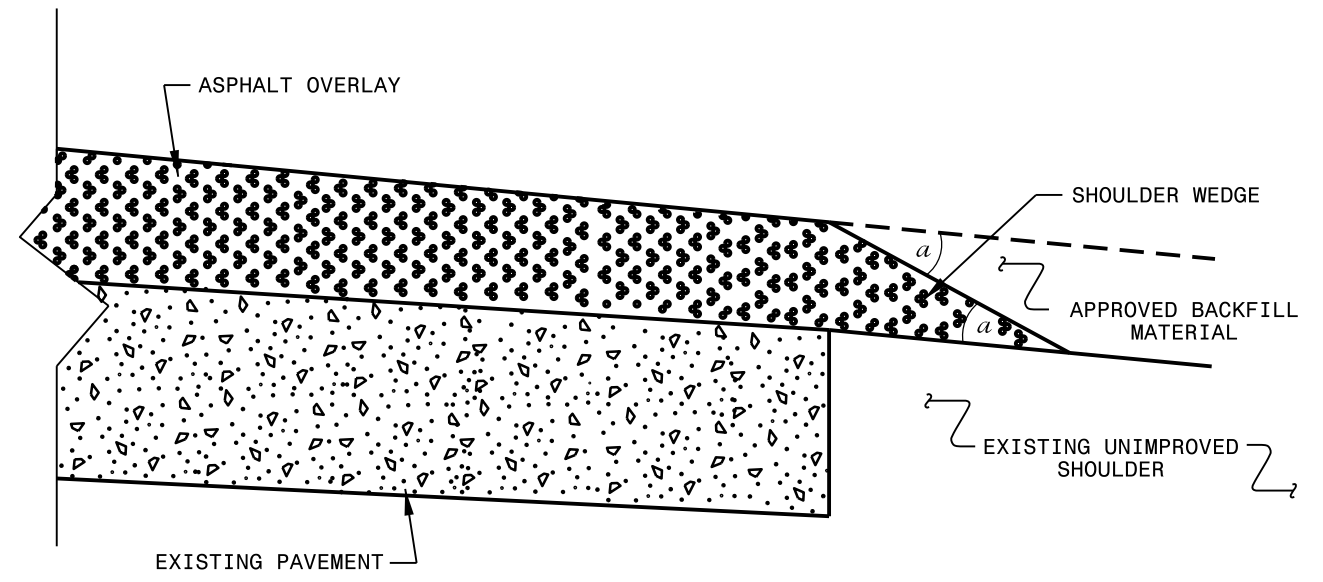

SHOULDER WEDGE DETAIL
 (Resurfacing Projects w/ NO Widening)

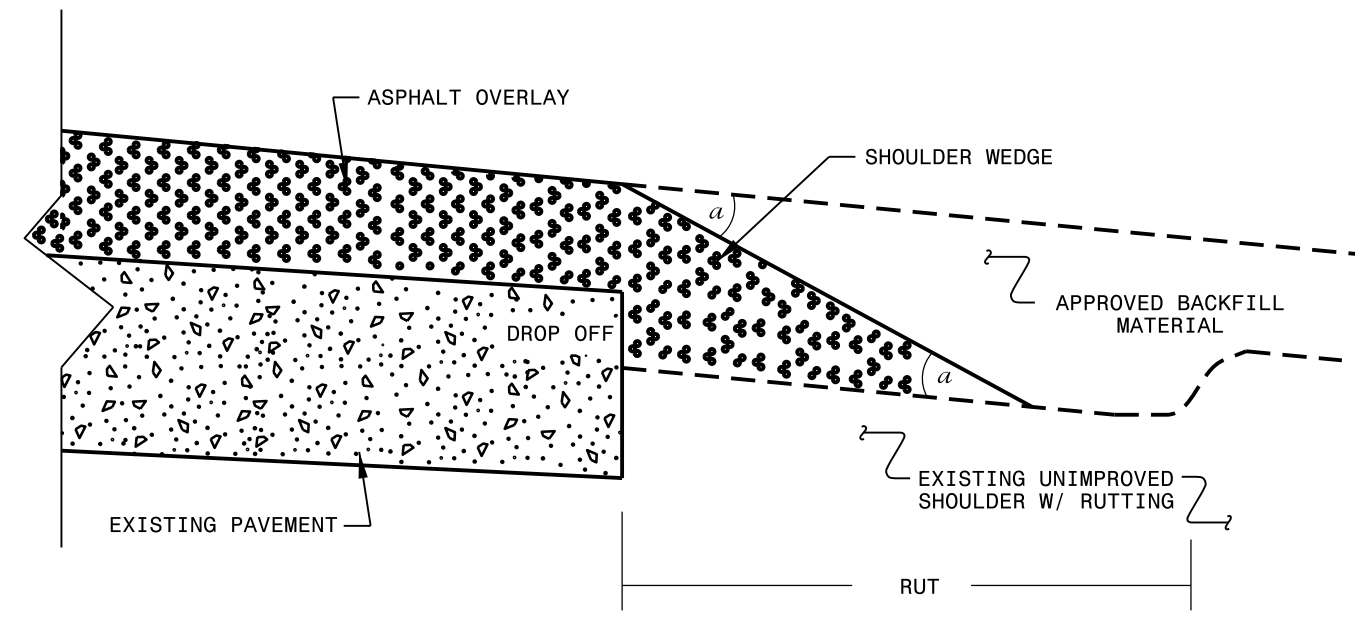

SHOULDER WEDGE DETAIL
 (Resurfacing Adjacent to
 Rutted Shoulder)

- SHOULDER WEDGE ANGLE = 30°

CONTRACT STANDARDS AND DEVELOPMENT UNIT			
Office 919-707-6950		FAX 919-250-4119	
SHOULDER WEDGE DETAILS			
ORIGINAL BY: T.SPELL	DATE: 7-19-11		
MODIFIED BY:	DATE: 10/16/12		
CHECKED BY:	DATE:		
FILE SPEC.: susr/details/stand/shoulderwedgedetail.dgn			

SYSTEM: 11/11/11
 USER: T.SPELL
 FILE: susr/details/stand/shoulderwedgedetail.dgn

SIGNING FOR RESURFACING PROJECTS

LEGEND

┃ STATIONARY SIGN

← DIRECTION OF TRAFFIC FLOW

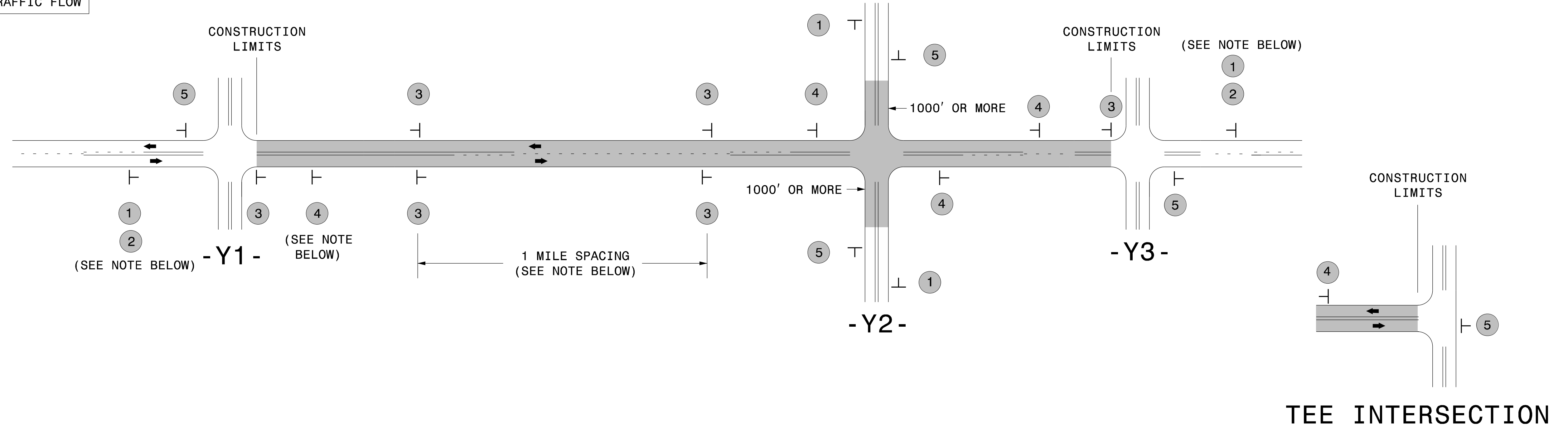

MAINLINE (-L-) SIGNING

-Y- LINE SIGNING

SIGNING NOTES AND PLACEMENT PER DIRECTION	1		PLACE 1000' PRIOR TO BEGINNING OF CONSTRUCTION LIMITS. ONLY USED ON -Y- LINES IF RESURFACING LIMITS EXTEND 1000' ALONG -Y- LINE.	<p>NO REQUIRED STATIONARY SIGNING FOR THE FOLLOWING -Y- LINE CONDITIONS:</p> <ol style="list-style-type: none"> 1) LESS THAN 1000' OF RESURFACING ALONG -Y- LINE 2) SUBDIVISION ROADS 3) DEAD END ROADS <p>WHEN PAVING/CONSTRUCTION ACTIVITIES PROCEED ACROSS AN UNSIGNED -Y- LINE, PORTABLE ADVANCE WARNING SIGNS SHALL BE USED ALONG THE -Y- LINE AS SHOWN BELOW. REMOVE UPON COMPLETION OF WORK.</p> <div style="display: flex; justify-content: space-around;"> <div style="text-align: center;"> W20-1 48" X 48" PLACED 500' IN ADVANCE OF FLAGGER. </div> <div style="text-align: center;"> W20-7 A 48" X 48" PLACED 250' IN ADVANCE OF FLAGGER. </div> </div>
	2		#2 SIGN ONLY USED WHEN CONSTRUCTION LIMITS ARE 2 OR MORE MILES IN LENGTH. ROUND UP TO NEXT WHOLE NUMBER. (NO FRACTIONAL OR DECIMAL NUMBERS)	
	3		- PLACE INITIALLY AT THE CONSTRUCTION LIMITS AND SPACE 1 MILE APART THEREAFTER. - AT TEE INTERSECTIONS INSTALL INITIALLY 1/2 MILE FROM INTERSECTION AND SPACE 1 MILE APART THEREAFTER.	
	4		- THESE ARE FOR -Y- LINES THAT ARE "THROUGH" ROADWAYS. - DEAD END AND SUBDIVISION ROADS ARE NOT "THROUGH" ROADWAYS. - INSTALL 500' +/- FROM EACH -Y- LINE APPROACH AS SHOWN ABOVE. - FOR MULTIPLE -Y- LINES THAT ARE SEPARATED BY 0.25 MILES OR LESS, TREAT AS A SINGLE UNIT AND INSTALL WITHIN 500' OF EACH APPROACH. - A MAXIMUM OF 2 SIGN SETS PER MILE. DO NOT INSTALL WHEN -Y- LINES ARE WITHIN 0.5 MILES FROM "END ROAD WORK" SIGN. - FOR TEE INTERSECTIONS, INSTALL WITHIN 500' +/- OF THE INTERSECTION ALONG -L- LINE.	
	5		PLACE 500' FOLLOWING THE END OF CONSTRUCTION LIMITS OR AS SHOWN WHEN WORK ENDS AT A 3-WAY TEE INTERSECTION.	

THE ABOVE SIGNS ARE ALL THAT ARE REQUIRED FOR A CONTRACTOR TO BEGIN A RESURFACING CONTRACT. ANY ADDITIONAL SIGNS REQUESTED BY NCDOT DIVISIONS SHALL BE INSTALLED WITHIN 7 BUSINESS DAYS OF THE START OF CONTRACT WORK.

MAPS LESS THAN 2 MILES

FOR RESURFACING MAPS WITH CONSTRUCTION LIMITS LESS THAN 2 MILES IN LENGTH, NO STATIONARY SIGNS ARE REQUIRED. USE PORTABLE "ROAD UNDER CONSTRUCTION" OR "ROAD WORK AHEAD" SIGNS IN LIEU OF STATIONARY ADVANCE WARNINGS SIGNS.

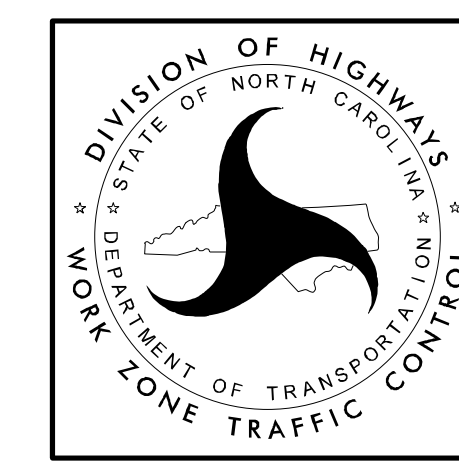

ADVANCE WARNING SIGNS FOR RURAL AND SUBURBAN 2-LANE ROADWAY RESURFACING

GUIDELINES FOR LANE WIDTHS ON RESURFACING PROJECTS

Contractor shall place the new pavement markings in accordance with this table and detail unless otherwise directed by the Engineer.

TWO LANE - TWO WAY ROADWAY - 55 MPH		
ROADWAY WIDTH	LANE WIDTH	SHOULDER WIDTH
18'	9' *	0'
20'	10' *	0'
22'	10'	1'
24'	10'	2'
26'	11'	2'
28'	12'	2'
32'	12'	4'

* May vary due to pavement width

TWO LANE - TWO WAY ROADWAY		50
MPH OR LESS		
ROADWAY WIDTH	LANE WIDTH	SHOULDER WIDTH
18'	9' *	0'
20'	10' *	0'
22'	10'	1'
24'	10'	2'
26'	11'	2'
28'	11'	3'
32'	11'	5'

* May vary due to pavement width

SCHEMATIC OF ROADWAY

(NOT TO SCALE)

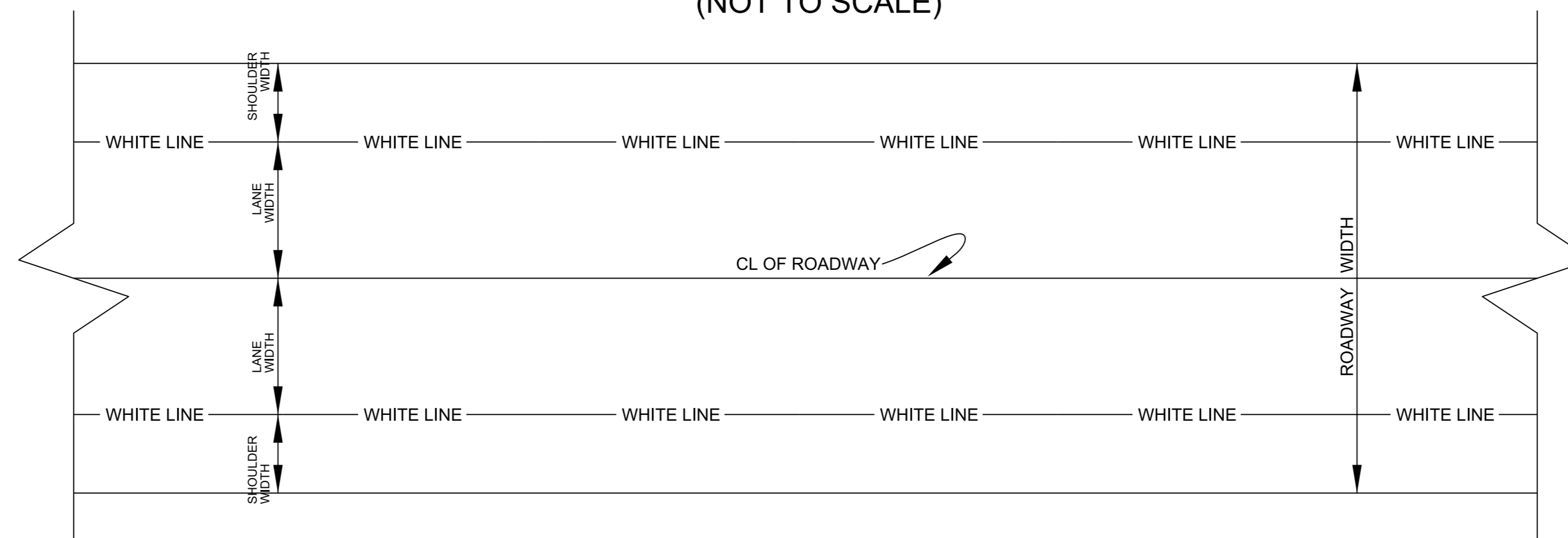

PROJECT NO.	SHEET NO.	TOTAL NO.
2026CPT.06.06.20781.1		

SUMMARY OF QUANTITIES

PROJECT NO	COUNTY	MAP NO	ROUTE	DESCRIPTION	TYP NO	LANES	LANE TYPE	LENGTH	WIDTH	BEG N	END MP	1220000000-E	1245000000-E	1260000000-E	1297000000-E	1330000000-E	1491000000-E	1519000000-E	1520000000-E	1575000000-E	1704000000-E	2845000000-N
												INCIDENTAL STONE BASE	SHOULDER RECONSTRUCT ION	AGGREGATE SHOULDER BORROW	5" MILLING	INCIDENTAL MILLING	BASE COURSE, B25.0C	SURFACE COURSE, S9.5B	LEVELING COURSE, S9.5B	ASPHALT BINDER FOR PLANT MIX	PATCHING EXISTING PAVEMENT	ADJ. OF METER OR VALVE BOX
												TONS	SMI	TON	SY	SY	TONS	TONS	TONS	TONS	TONS	EA
2026CPT.06.06.20781.1	Robeson	1	SR-2282 / AFFINITY RD	NC 904 TO SC LINE	1	2	2WU	2.95	20	0	2.95	33	5.90	954		1,508	441	3,071	10	228	5	
TOTAL FOR MAP NO. 1								2.95				33	5.90	954		1,508	441	3,071	10	228	5	
2026CPT.06.06.20781.1	Robeson	2	SR-2283 / PAGE CIR	FROM SR 2282 TO SR 2282	1	2	2WU	2.56	20	0	2.56	20	5.12	1,404		467	51	2,369	10	163	5	
TOTAL FOR MAP NO. 2								2.56				20	5.12	1,404		467	51	2,369	10	163	5	
2026CPT.06.06.20781.1	Robeson	3	SR-2280 / ALLIGATOR BRANCH RD	FROM DEAD END TO SR 2277	1	2	2WU	0.95	20	0	0.95	17	1.90	307		531		944	10	65	4	
TOTAL FOR MAP NO. 3								0.95				17	1.90	307		531		944	10	65	4	
2026CPT.06.06.20781.1	Robeson	4	SR-2285 / OLIVER FARM RD	FROM NC 904 TO SR 2282	1	2	2WU	0.84	20	0	0.84	3	1.68	272	176	492	124	857	10	64	5	
TOTAL FOR MAP NO. 4								0.84				3	1.68	272	176	492	124	857	10	64	5	
2026CPT.06.06.20781.1	Robeson	5	SR-2448 / TOOGAN RD	FROM SR 2449 TO SR 2453	1	2	2WU	1.87	20	0	1.87	45	3.74	605			147	1,849	10	133	2	
TOTAL FOR MAP NO. 5								1.87				45	3.74	605		147	1,849	10	133	2		
2026CPT.06.06.20781.1	Robeson	6	SR-2236 / TURKEY BRANCH RD	FROM SR 1003 TO NC 41	1	2	2WU	0.76	20	0	0.76	45	1.52	246			40	857	10	61	6	
TOTAL FOR MAP NO. 6								0.76				45	1.52	246		40	857	10	61	6		
2026CPT.06.06.20781.1	Robeson	7	SR-2218 / WILTON DR	FROM SR 2214 TO SR 2220	1	2	2WU	0.98	20	0	0.98	25	1.96	317		650	309	1,055	10	88	3	
TOTAL FOR MAP NO. 7								0.98				25	1.96	317		650	309	1,055	10	88	3	
2026CPT.06.06.20781.1	Robeson	8	SR-2327 / FAULK RD	FROM SR 2218 TO DEAD END	2	2	2WU	0.09	20	0	0.09	2						58		5	2	
TOTAL FOR MAP NO. 8								0.09				2						58		5	2	
2026CPT.06.06.20781.1	Robeson	9	SR-2208 / WIRE GRASS RD	FROM NC-41 TO NC-130	1	2	2WU	8.72	24.5	0	8.72	197	17.44	2,820		3,716	382	10,713	10	737	5	
TOTAL FOR MAP NO. 9								8.72				197	17.44	2,820		3,716	382	10,713	10	737	5	
2026CPT.06.06.20781.1	Robeson	10	SR-2337 / GEM RD	FROM SR 2218 TO DEAD END	2	2	2WU	0.46	20	0	0.46	33						337	10	26	26	
TOTAL FOR MAP NO. 10								0.46				33						337	10	26	26	
2026CPT.06.06.20781.1	Robeson	11	SR-2338 / DIAMOND CIR	FROM SR 2337 TO DEAD END	2	2	2WU	0.1	18	0	0.1	10						102	10	9	2	1
TOTAL FOR MAP NO. 11								0.1				10						102	10	9	2	1
2026CPT.06.06.20781.1	Robeson	12	SR-2339 / SILVER CIR	FROM SR 2337 TO DEAD END	2	2	2WU	0.08	18	0	0.08	8						91	10	8	2	2
TOTAL FOR MAP NO. 12								0.08				8						91	10	8	2	2
2026CPT.06.06.20781.1	Robeson	13	SR-2466 / MITCHELL RD	FROM SR 2455 TO SR 2435	1	2	2WU	1.85	20	0	1.85	33	3.70	598			99	1,817	10	128	10	
TOTAL FOR MAP NO. 13								1.85				33	3.70	598		99	1,817	10	128	10		
TOTAL FOR PROJ NO. 2026CPT.06.06.20781.1								22.21				471	42.96	7,523	176	7,364	1,593	24,120	120	1,715	77	3
GRAND TOTAL								22.21				471	42.96	7,523	176	7,364	1,593	24,120	120	1,715	77	3

PROJECT NO.	SHEET NO.	TOTAL NO.
2026CPT.06.06.20781.1		

THERMOPLASTIC AND PAINT QUANTITIES

PROJECT NO	COUNTY	MAP NO	ROUTE	DESCRIPTION	TYP NO	LANES	LANE TYPE	LENGTH	WIDTH	BEGIN MP	END MP	4413000000-E	4685000000-E	4900000000-N	
												WORK ZONE ADVANCE/GE NERAL WARNING SIGNING	4" X 90 M WHITE THERMO	4" X 90 M YELLOW THERMO	YELLOW & YELLOW MARKERS
												MI	FT	SF	LF
2026CPT.06.06.20781.1	Robeson	1	SR-2282 / AFFINITY RD	NC 904 TO SC LINE	1	2	2WU	2.95	20	0	2.95	330	32,680	21,806	195
TOTAL FOR MAP NO. 1								2.95				330	32,680	21,806	195
2026CPT.06.06.20781.1	Robeson	2	SR-2283 / PAGE CIR	FROM SR 2282 TO SR 2282	1	2	2WU	2.56	20	0	2.56	287	27,291	18,924	169
TOTAL FOR MAP NO. 2								2.56				287	27,291	18,924	169
2026CPT.06.06.20781.1	Robeson	3	SR-2280 / ALLIGATOR BRANCH RD	FROM DEAD END TO SR 2277	1	2	2WU	0.95	20	0	0.95	106	10,334	7,023	63
TOTAL FOR MAP NO. 3								0.95				106	10,334	7,023	63
2026CPT.06.06.20781.1	Robeson	4	SR-2285 / OLIVER FARM RD	FROM NC 904 TO SR 2282	1	2	2WU	0.84	20	0	0.84	94	9,143	6,210	55
TOTAL FOR MAP NO. 4								0.84				94	9,143	6,210	55
2026CPT.06.06.20781.1	Robeson	5	SR-2448 / TOOGAN RD	FROM SR 2449 TO SR 2453	1	2	2WU	1.87	20	0	1.87	209	19,747	13,823	123
TOTAL FOR MAP NO. 5								1.87				209	19,747	13,823	123
2026CPT.06.06.20781.1	Robeson	6	SR-2236 / TURKEY BRANCH RD	FROM SR 1003 TO NC 41	1	2	2WU	0.76	20	0	0.76	85	8,026	5,618	50
TOTAL FOR MAP NO. 6								0.76				85	8,026	5,618	50
2026CPT.06.06.20781.1	Robeson	7	SR-2218 / WILTON DR	FROM SR 2214 TO SR 2220	1	2	2WU	0.98	20	0	0.98	110	10,612	7,244	65
TOTAL FOR MAP NO. 7								0.98				110	10,612	7,244	65
2026CPT.06.06.20781.1	Robeson	8	SR-2327 / FAULK RD	FROM SR 2218 TO DEAD END	2	2	2WU	0.09	20	0	0.09	10			
TOTAL FOR MAP NO. 8								0.09				10			
2026CPT.06.06.20781.1	Robeson	9	SR-2208 / WIRE GRASS RD	FROM NC-41 TO NC-130	1	2	2WU	8.72	24.5	0	8.72	977	93,821	64,310	576
TOTAL FOR MAP NO. 9								8.72				977	93,821	64,310	576
2026CPT.06.06.20781.1	Robeson	10	SR-2337 / GEM RD	FROM SR 2218 TO DEAD END	2	2	2WU	0.46	20	0	0.46	52			
TOTAL FOR MAP NO. 10								0.46				52			
2026CPT.06.06.20781.1	Robeson	11	SR-2338 / DIAMOND CIR	FROM SR 2337 TO DEAD END	2	2	2WU	0.1	18	0	0.1	11			
TOTAL FOR MAP NO. 11								0.1				11			
2026CPT.06.06.20781.1	Robeson	12	SR-2339 / SILVER CIR	FROM SR 2337 TO DEAD END	2	2	2WU	0.08	18	0	0.08	9			
TOTAL FOR MAP NO. 12								0.08				9			
2026CPT.06.06.20781.1	Robeson	13	SR-2466 / MITCHELL RD	FROM SR 2455 TO SR 2435	1	2	2WU	1.85	20	0	1.85	207	19,536	13,675	122
TOTAL FOR MAP NO. 13								1.85				207	19,536	13,675	122
TOTAL FOR PROJ NO. 2026CPT.06.06.20781.1								22.21				2,487	231,190	158,633	1,418
												389,823			
GRAND TOTAL								22.21				2,487	231,190	158,633	1,418
												389,823			